



Panorama Road
Swanage, BH19 2QS



**Offers
Over**



Panorama Road

Swanage, BH19 2QS

- Holiday Caravan with Sensational Sea Views
- Two Bedrooms, Six Berth
- Open Plan Kitchen / Living /Diner
- Family Bathroom and En Suite Cloakroom to Main Bedroom
- Driveway Parking
- Large Sea-Facing Balcony
- Amenities On Site include Swimming Pool
- Successful Holiday Let - Potential for Increase in Current Revenue
- Pathways to Jurassic Coast Nearby
- Perfect Family Getaway





****HOLIDAY CARAVAN WITH FABULOUS VIEWS - FAMILY GETAWAY OR INVESTMENT OPPORTUNITY****

Nestled within the picturesque Swanage Bay View caravan park, this charming 2022 ABI "Beverley" caravan offers a delightful retreat with breathtaking views over the town and bay, extending to the Isle of Wight in the distance. Measuring 36' x 12' this property is designed for comfort and relaxation, making it an ideal getaway.

The caravan features two well-appointed double bedrooms. The



main bedroom boasts an en suite cloakroom and generous fitted wardrobes, providing ample storage space. The second bedroom is thoughtfully configured as a twin, also equipped with fitted wardrobes, ensuring that guests or family members enjoy their own comfortable space.

The heart of the home is the open-plan kitchen, living, and dining area, which is flooded with natural light thanks to the French doors that frame the stunning panoramic views. The modern kitchen is fitted with a range of appliances, making it perfect for preparing meals and entertaining.

Outside, the property is complemented by a lovely decking area, ideal for summer barbecues or simply soaking in the serene surroundings. Additionally, parking is conveniently located right outside the caravan, adding to the ease of access.



Whether you are seeking a holiday home or an investment opportunity this property at Swanage Bay View offers a unique opportunity to enjoy coastal living in a beautiful setting and is successfully holiday let with an income of circa £13,000 per annum. With its enchanting views and modern amenities, it is a must-see for anyone looking to embrace the charm of Swanage.

Panorama Road, Swanage, BH19

Approximate Area = 422 sq ft / 39.2 sq m

For identification only - Not to scale

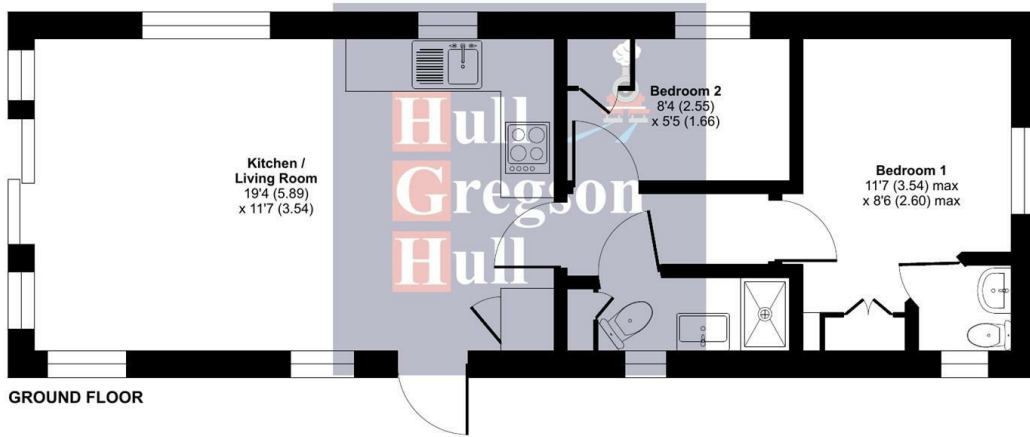

GROUND FLOOR

Floor plan produced in accordance with RICS Property Measurement 2nd Edition, incorporating International Property Measurement Standards (IPMS2 Residential). © nichecom 2025. Produced for Hull Gregson & Hull (Swanage) Ltd. REF: 1388337

Kitchen / Living / Dining Room

19'3" x 11'7" (5.89 x 3.54)

Bedroom One

11'7" x 8'6" (3.54 x 2.60)

Bedroom Two

8'4" x 5'5" (2.55 x 1.66)

Shower Room

Ensuite W.C

Parking Space

Additional Information.

The following details have been provided by the vendor, as required by Trading Standards. These details should be checked by your legal representative for accuracy.

Property type: Holiday Caravan

Property construction: Standard

Tenure: Held on a 20 year licence (from 2022). The site fees are approximately £8776.61 per annum and include water rates. Council Rate is approximately £280 per annum. The site is closed annually from 15 January and reopens on 1 March. The caravan may be used by the owners as a holiday residence only and owners must have a permanent residence for which proof will be required. Holiday lets are permitted as are pets subject to site T's&C's.

Mains Electricity

Mains Water & Sewage: Supplied by Wessex Water

Heating Type: LPG Gas- arranged by the site.

Broadband/Mobile signal/coverage: For further details please see the Ofcom Mobile Signal & Broadband checker. checker.ofcom.org.uk/

Disclaimer.

These particulars, whilst believed to be accurate are set out as a general outline only for guidance and do not constitute any part of an offer or contract. Intending purchasers should not rely on them as statements of representation of fact but must satisfy themselves by inspection or otherwise as to their accuracy. All measurements are approximate. Any details including (but not limited to): lease details, service charges, ground rents, property construction, services, & covenant information are provided by the vendor, and you should consult with your legal advisor/ satisfy yourself before proceeding. No person in this firm's employment has the authority to make or give any representation or warranty in respect of the property.

